

Dk-Lok USA

161 West I-65 Service Road

Mobile, AL 36608

Phone: (251) 472-9580

Fax: (251) 450-0962 or (800) 287-8186

info@dklokusa.com

GHB Series Reducing Hex Bushing Fittings

Green Instrument thread Fittings have been developed based on ASME B31.3 for instrumentation and process control in sizes 1/8" to 2". Green Thread and weld fittings have a wrench flat allowing standard Hex wrench assembly. This is one of the Green Pipe fitting benefits.



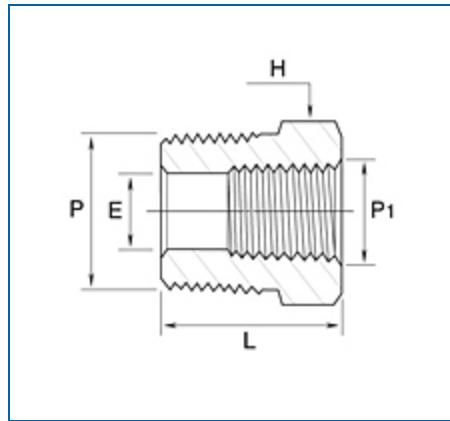

Male NPT to reduced female NPT



1 2

<u>Item #</u>	<u>Material</u>	<u>P - Male Pipe Size</u>	<u>P1 - Female Pipe Size</u>	<u>L</u>	<u>E</u>	<u>H - Hex</u>	<u>CAD</u>
<u>GHB-4-2N-S</u>	Stainless Steel 316/316L Dual Grade	1/4	1/8	26.7 mm	7.1 mm	14.2 mm	
<u>GHB-6-2N-S</u>	Stainless Steel 316/316L Dual Grade	3/8	1/8	21.8 mm	8.5 mm	17.4 mm	
<u>GHB-6-4N-S</u>	Stainless Steel 316/316L Dual Grade	3/8	1/4	30.0 mm	9.6 mm	19.1 mm	
<u>GHB-8-2N-S</u>	Stainless Steel 316/316L Dual Grade	1/2	1/8	27.4 mm	8.5 mm	22.2 mm	
<u>GHB-8-4N-S</u>	Stainless Steel 316/316L Dual Grade	1/2	1/4	27.4 mm	11.7 mm	22.2 mm	

<u>Item #</u>	<u>Material</u>	<u>P - Male Pipe Size</u>	<u>P1 - Female Pipe Size</u>	<u>L</u>	<u>E</u>	<u>H - Hex</u>	<u>CAD</u>
<u>GHB-8-6N-S</u>	Stainless Steel 316/316L Dual Grade	1/2	3/8	35.6 mm	11.9 mm	22.2 mm	
<u>GHB-12-4N-S</u>	Stainless Steel 316/316L Dual Grade	3/4	1/4	27.4 mm	11.4 mm	26.9 mm	
<u>GHB-12-6N-S</u>	Stainless Steel 316/316L Dual Grade	3/4	3/8	27.4 mm	15.0 mm	26.9 mm	
<u>GHB-12-8N-S</u>	Stainless Steel 316/316L Dual Grade	3/4	1/2	41.4 mm	15.7 mm	26.9 mm	
<u>GHB-16-4N-S</u>	Stainless Steel 316/316L Dual Grade	1	1/4	34.8 mm	11.4 mm	34.9 mm	
<u>GHB-16-8N-S</u>	Stainless Steel 316/316L Dual Grade	1	1/2	34.8 mm	18.5 mm	34.9 mm	
<u>GHB-16-12N- S</u>	Stainless Steel 316/316L Dual Grade	1	3/4	34.8 mm	22.4 mm	34.9 mm	
<u>GHB-4-2N-C</u>	Carbon Steel	1/4	1/8	26.7 mm	7.1 mm	14.2 mm	
<u>GHB-6-2N-C</u>	Carbon Steel	3/8	1/8	21.8 mm	8.5 mm	17.4 mm	
<u>GHB-6-4N-C</u>	Carbon Steel	3/8	1/4	30.0 mm	9.6 mm	19.1 mm	
<u>GHB-8-2N-C</u>	Carbon Steel	1/2	1/8	27.4 mm	8.5 mm	22.2 mm	
<u>GHB-8-4N-C</u>	Carbon Steel	1/2	1/4	27.4 mm	11.7 mm	22.2 mm	
<u>GHB-8-6N-C</u>	Carbon Steel	1/2	3/8	35.6 mm	11.9 mm	22.2 mm	
<u>GHB-12-4N- C</u>	Carbon Steel	3/4	1/4	27.4 mm	11.4 mm	26.9 mm	
<u>GHB-12-6N- C</u>	Carbon Steel	3/4	3/8	27.4 mm	15.0 mm	26.9 mm	

<u>Item #</u>	<u>Material</u>	<u>P - Male Pipe Size</u>	<u>P1 - Female Pipe Size</u>	<u>L</u>	<u>E</u>	<u>H - Hex</u>	<u>CAD</u>
<u>GHB-12-8N- C</u>	Carbon Steel	3/4	1/2	41.4 mm	15.7 mm	26.9 mm	
<u>GHB-16-4N- C</u>	Carbon Steel	1	1/4	34.8 mm	11.4 mm	34.9 mm	
<u>GHB-16-8N- C</u>	Carbon Steel	1	1/2	34.8 mm	18.5 mm	34.9 mm	
<u>GHB-16-12N- C</u>	Carbon Steel	1	3/4	34.8 mm	22.4 mm	34.9 mm	
<u>GHB-4-2N-B</u>	Brass	1/4	1/8	26.7 mm	7.1 mm	14.2 mm	